

# FOR LEASE

## Central Plaza



Central Plaza is located on Central between Oliver and Edgemoor in the well-established Crown Heights area. The center benefits from excellent drive-by traffic along Central Avenue. Tenants include Papa Johns of Wichita and a Farmers Insurance Agency.

**Location:** 5231 E. Central, Wichita, KS

**Space Available:** 1,000 sq. ft.

**Lease Rate:** \$12.00 sq. ft. NNN

**Demographics:** Est. Average Household Income  
1 Mile = \$67,204 3 Miles = \$52,304 5 Miles = \$53,497

**Signage:** Pylon Signage is available

**Area Neighbors:** Sonic, Dairy Queen, Quik Trip, Burger King, McDonald's, 1 Hour Picture Perfect, Interstate Battery Center, Jiffy Lube and Box Central.

**For More Information Contact:**

Chad Stafford

T: (316) 262-3331

F: (316) 262-6321

C: (720) 289-5824

chad@occmgmt.com

www.occmgmt.com



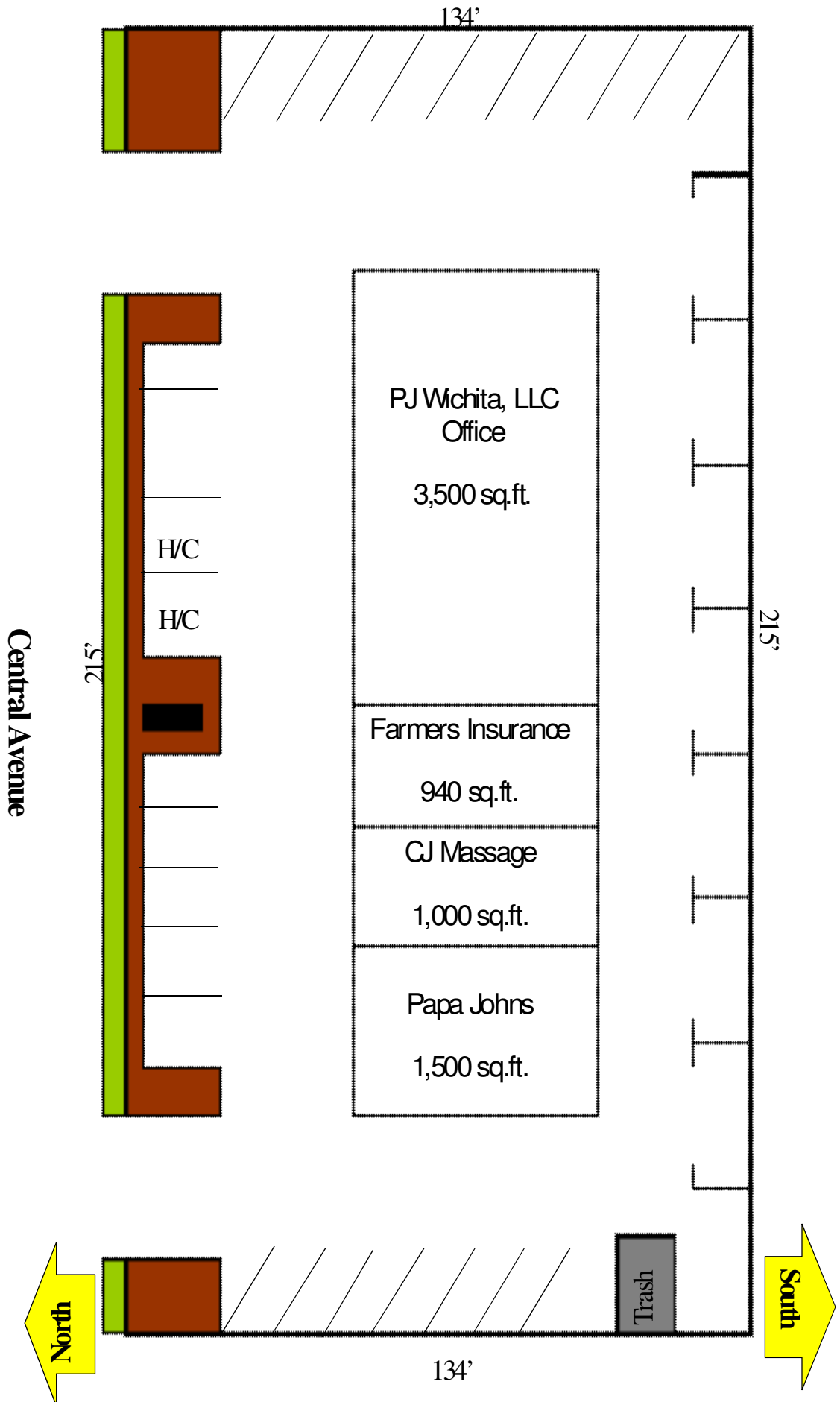

5231 E CENTRAL AVE  
WICHITA A.K.S 67208-4197  
Coord: 37.693658, -97.275528  
Radius - See Appendix for Details

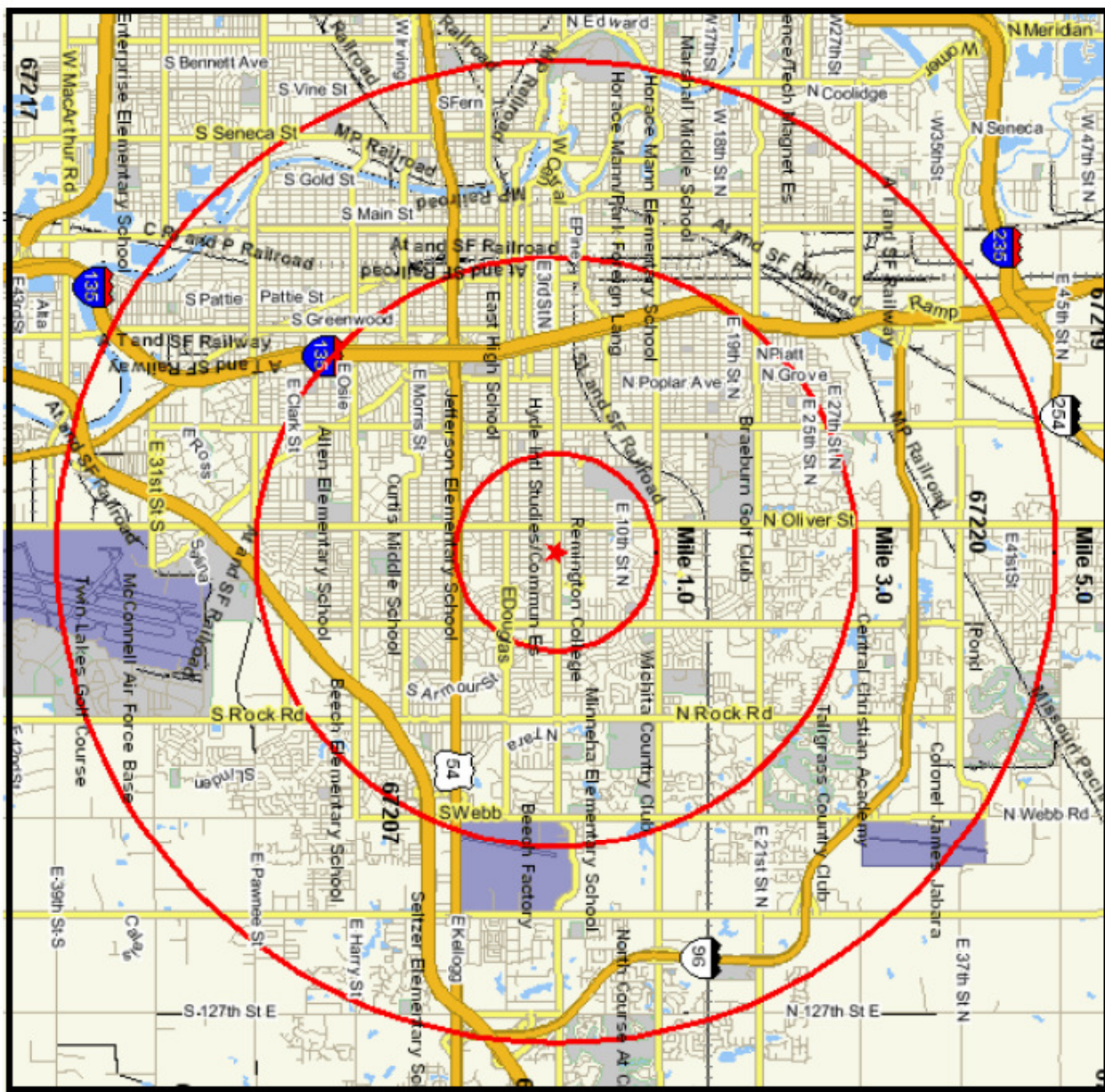

★	Point
Yellow double line	Interstate Highways
Orange double line	US Highways
Yellow single line	State Highways
Orange single line	Major Highways
Yellow dashed line	Major Roads
Grey dashed line	Roads
Black dashed line	Railroads
Green square	Landmarks
Light green square	Parks
Blue square	Hydrography
Light blue square	Airports
White square	Zip Code

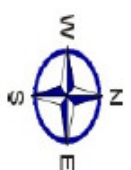

## Pop-Facts: Household Quick Facts Report

Radius 1: 5231 E CENTRAL AVE, WICHITA, KS 67208-4197, aggregate

Radius 2: 5231 E CENTRAL AVE, WICHITA, KS 67208-4197, aggregate

Radius 3: 5231 E CENTRAL AVE, WICHITA, KS 67208-4197, aggregate

Description	0.00 - 1.00 miles		0.00 - 3.00 miles		0.00 - 5.00 miles	
	Radius 1	%	Radius 2	%	Radius 3	%
<b>Households</b>						
2014 Projection	5,475		41,899		84,366	
2009 Estimate	5,421		41,698		83,336	
2000 Census	5,446		42,174		82,832	
1990 Census	5,506		41,707		79,123	
Growth 2009 - 2014	1.00%		0.48%		1.24%	
Growth 2000 - 2009	-0.46%		-1.13%		0.61%	
Growth 1990 - 2000	-1.09%		1.12%		4.69%	
<b>2009 Est. Households by Household Income</b>						
	5,421		41,698		83,336	
Income Less than \$15,000	518	9.56	7,588	18.20	13,613	16.34
Income \$15,000 - \$24,999	524	9.67	6,048	14.50	11,583	13.90
Income \$25,000 - \$34,999	683	12.60	5,866	14.07	11,682	14.02
Income \$35,000 - \$49,999	896	16.53	6,898	16.54	14,162	16.99
Income \$50,000 - \$74,999	1,232	22.73	7,556	18.12	15,683	18.82
Income \$75,000 - \$99,999	673	12.41	3,556	8.53	7,826	9.39
Income \$100,000 - \$149,999	589	10.87	2,615	6.27	5,735	6.88
Income \$150,000 - \$249,999	202	3.73	966	2.32	1,997	2.40
Income \$250,000 - \$499,999	68	1.25	406	0.97	724	0.87
Income \$500,000 or more	37	0.68	198	0.47	331	0.40
<b>2009 Est. Average Household Income</b>						
	\$67,204		\$52,304		\$53,497	
<b>2009 Est. Median Household Income</b>						
	\$51,835		\$37,929		\$40,074	
<b>2009 Est. Per Capita Income</b>						
	\$28,115		\$22,992		\$22,482	
<b>2009 Est. Households by Household Type</b>						
	5,421		41,698		83,336	
Family Households	3,398	62.68	23,386	56.08	48,468	58.16
Nonfamily Households	2,023	37.32	18,311	43.91	34,868	41.84
<b>2009 Est. Group Quarters Population</b>						
	107		1,182		4,219	



## Pop-Facts: Household Quick Facts Report

Radius 1: 5231 E CENTRAL AVE, WICHITA, KS 67208-4197, aggregate

Radius 2: 5231 E CENTRAL AVE, WICHITA, KS 67208-4197, aggregate

Radius 3: 5231 E CENTRAL AVE, WICHITA, KS 67208-4197, aggregate

Description	0.00 - 1.00 miles		0.00 - 3.00 miles		0.00 - 5.00 miles	
	<i>Radius 1</i>	%	<i>Radius 2</i>	%	<i>Radius 3</i>	%
<b>2009 Est. Households by Household Size*</b>	5,421		41,698		83,336	
1-person household	1,659	30.60	15,443	37.04	29,147	34.98
2-person household	1,868	34.46	12,875	30.88	25,005	30.01
3-person household	826	15.24	5,917	14.19	12,058	14.47
4-person household	578	10.66	4,112	9.86	9,251	11.10
5-person household	324	5.98	2,085	5.00	4,689	5.63
6-person household	106	1.96	794	1.90	1,952	2.34
7 or more person household	61	1.13	472	1.13	1,235	1.48
<b>2009 Est. Average Household Size</b>	2.38		2.26		2.37	
<b>2009 Est. Household Type, Presence Own Children*</b>	5,421		41,698		83,336	
Single Male Householder	657	12.12	6,960	16.69	13,885	16.66
Single Female Householder	1,002	18.48	8,483	20.34	15,261	18.31
Married-Couple Family, own children	1,115	20.57	6,798	16.30	16,312	19.57
Married-Couple Family, no own children	1,442	26.60	9,204	22.07	18,288	21.94
Male Householder, own children	95	1.75	895	2.15	1,944	2.33
Male Householder, no own children	71	1.31	807	1.94	1,618	1.94
Female Householder, own children	454	8.37	3,626	8.70	6,622	7.95
Female Householder, no own children	220	4.06	2,056	4.93	3,684	4.42
Nonfamily, Male Householder	217	4.00	1,758	4.22	3,471	4.17
Nonfamily, Female Householder	147	2.71	1,110	2.66	2,251	2.70

\*In contrast to Claritas Demographic Estimates, "smoothed" data items are Census 2000 tables made consistent with current year estimated and 5 year projected base counts.



## Pop-Facts: Population Quick Facts Report

Radius 1: 5231 E CENTRAL AVE, WICHITA, KS 67208-4197, aggregate

Radius 2: 5231 E CENTRAL AVE, WICHITA, KS 67208-4197, aggregate

Radius 3: 5231 E CENTRAL AVE, WICHITA, KS 67208-4197, aggregate

Description	0.00 - 1.00 miles <i>Radius 1</i>		0.00 - 3.00 miles <i>Radius 2</i>		0.00 - 5.00 miles <i>Radius 3</i>	
<b>Population</b>						
2014 Projection	13,116		95,216		203,233	
2009 Estimate	13,000		95,435		201,409	
2000 Census	13,115		97,803		201,563	
1990 Census	13,084		99,230		191,509	
Growth 2009 - 2014	0.89%		-0.23%		0.91%	
Growth 2000 - 2009	-0.88%		-2.42%		-0.08%	
Growth 1990 - 2000	0.24%		-1.44%		5.25%	
<b>2009 Est. Population by Age</b>						
	13,000		95,435		201,409	
Age 0 - 4	1,040	8.00	7,337	7.69	16,621	8.25
Age 5 - 9	1,013	7.79	6,862	7.19	15,254	7.57
Age 10 - 14	951	7.32	6,534	6.85	14,249	7.07
Age 15 - 17	538	4.14	3,620	3.79	7,728	3.84
Age 18 - 20	411	3.16	3,774	3.95	7,933	3.94
Age 21 - 24	627	4.82	5,314	5.57	10,892	5.41
Age 25 - 34	1,671	12.85	14,309	14.99	30,445	15.12
Age 35 - 44	1,845	14.19	12,780	13.39	28,490	14.15
Age 45 - 49	871	6.70	6,102	6.39	13,389	6.65
Age 50 - 54	904	6.95	6,298	6.60	13,271	6.59
Age 55 - 59	807	6.21	5,467	5.73	11,236	5.58
Age 60 - 64	602	4.63	4,231	4.43	8,606	4.27
Age 65 - 74	786	6.05	5,831	6.11	10,933	5.43
Age 75 - 84	638	4.91	4,675	4.90	8,224	4.08
Age 85 and over	297	2.28	2,298	2.41	4,139	2.06
Age 16 and over	9,788	75.29	73,441	76.95	152,649	75.79
Age 18 and over	9,438	72.75	71,081	74.48	147,557	73.26
Age 21 and over	9,047	69.59	67,307	70.53	139,624	69.32
Age 65 and over	1,721	13.24	12,805	13.42	23,295	11.57
<b>2009 Est. Median Age</b>						
	36.35		34.98		34.21	
<b>2009 Est. Average Age</b>						
	37.11		36.99		35.86	



## Pop-Facts: Population Quick Facts Report

Radius 1: 5231 E CENTRAL AVE, WICHITA, KS 67208-4197, aggregate

Radius 2: 5231 E CENTRAL AVE, WICHITA, KS 67208-4197, aggregate

Radius 3: 5231 E CENTRAL AVE, WICHITA, KS 67208-4197, aggregate

Description	0.00 - 1.00 miles		0.00 - 3.00 miles		0.00 - 5.00 miles	
	Radius 1	%	Radius 2	%	Radius 3	%
<b>2009 Est. Population by Single Race Classification</b>	13,000		95,435		201,409	
White Alone	8,947	68.82	54,701	57.32	124,971	62.05
Black or African American Alone	2,962	22.78	25,876	27.11	37,135	18.44
American Indian and Alaska Native Alone	82	0.63	907	0.95	2,101	1.04
Asian Alone	309	2.38	5,125	5.37	11,400	5.66
Native Hawaiian and Other Pacific Islander Alone	10	0.08	109	0.11	183	0.09
Some Other Race Alone	322	2.48	5,070	5.31	17,952	8.91
Two or More Races	367	2.82	3,648	3.82	7,668	3.81
<b>2009 Est. Population Hispanic or Latino</b>	13,000		95,435		201,409	
Hispanic or Latino	683	5.25	10,396	10.89	33,556	16.66
Not Hispanic or Latino	12,317	94.75	85,039	89.11	167,853	83.34
<b>2009 Est. Population by Sex</b>	13,000		95,435		201,409	
Male	6,251	48.08	46,394	48.61	100,023	49.66
Female	6,749	51.92	49,041	51.39	101,386	50.34
Male/Female Ratio	0.93		0.95		0.99	

## Pop-Facts: Demographic Quick Facts Report

Radius 1: 5231 E CENTRAL AVE, WICHITA, KS 67208-4197, aggregate

Radius 2: 5231 E CENTRAL AVE, WICHITA, KS 67208-4197, aggregate

Radius 3: 5231 E CENTRAL AVE, WICHITA, KS 67208-4197, aggregate

Description	0.00 - 1.00 miles <i>Radius 1</i>		0.00 - 3.00 miles <i>Radius 2</i>		0.00 - 5.00 miles <i>Radius 3</i>	
<b>Population</b>						
2014 Projection	13,116		95,216		203,233	
2009 Estimate	13,000		95,435		201,409	
2000 Census	13,115		97,803		201,563	
1990 Census	13,084		99,230		191,509	
Growth 1990 - 2000	0.24%		-1.44%		5.25%	
<b>Households</b>						
2014 Projection	5,475		41,899		84,366	
2009 Estimate	5,421		41,698		83,336	
2000 Census	5,446		42,174		82,832	
1990 Census	5,506		41,707		79,123	
Growth 1990 - 2000	-1.09%		1.12%		4.69%	
<b>2009 Est. Population by Single Classification Race</b>						
White Alone	8,947	68.82	54,701	57.32	124,971	62.05
Black or African American Alone	2,962	22.78	25,876	27.11	37,135	18.44
American Indian and Alaska Native Alone	82	0.63	907	0.95	2,101	1.04
Asian Alone	309	2.38	5,125	5.37	11,400	5.66
Native Hawaiian and Other Pacific Islander Alone	10	0.08	109	0.11	183	0.09
Some Other Race Alone	322	2.48	5,070	5.31	17,952	8.91
Two or More Races	367	2.82	3,648	3.82	7,668	3.81
<b>2009 Est. Population Hispanic or Latino</b>						
Hispanic or Latino	683	5.25	10,396	10.89	33,556	16.66
Not Hispanic or Latino	12,317	94.75	85,039	89.11	167,853	83.34
<b>2009 Tenure of Occupied Housing Units</b>						
Owner Occupied	3,910	72.13	22,344	53.59	45,182	54.22
Renter Occupied	1,510	27.85	19,354	46.41	38,154	45.78
<b>2009 Average Household Size</b>						
	2.38		2.26		2.37	



## Pop-Facts: Demographic Quick Facts Report

Radius 1: 5231 E CENTRAL AVE, WICHITA, KS 67208-4197, aggregate

Radius 2: 5231 E CENTRAL AVE, WICHITA, KS 67208-4197, aggregate

Radius 3: 5231 E CENTRAL AVE, WICHITA, KS 67208-4197, aggregate

Description	0.00 - 1.00 miles <i>Radius 1</i>		0.00 - 3.00 miles <i>Radius 2</i>		0.00 - 5.00 miles <i>Radius 3</i>	
		%		%		%
<b>2009 Est. Households by Household Income</b>	5,421		41,698		83,336	
Income Less than \$15,000	518	9.56	7,588	18.20	13,613	16.34
Income \$15,000 - \$24,999	524	9.67	6,048	14.50	11,583	13.90
Income \$25,000 - \$34,999	683	12.60	5,866	14.07	11,682	14.02
Income \$35,000 - \$49,999	896	16.53	6,898	16.54	14,162	16.99
Income \$50,000 - \$74,999	1,232	22.73	7,556	18.12	15,683	18.82
Income \$75,000 - \$99,999	673	12.41	3,556	8.53	7,826	9.39
Income \$100,000 - \$149,999	589	10.87	2,615	6.27	5,735	6.88
Income \$150,000 - \$249,999	202	3.73	966	2.32	1,997	2.40
Income \$250,000 - \$499,999	68	1.25	406	0.97	724	0.87
Income \$500,000 and over	37	0.68	198	0.47	331	0.40
<b>2009 Est. Average Household Income</b>	\$67,204		\$52,304		\$53,497	
<b>2009 Est. Median Household Income</b>	\$51,835		\$37,929		\$40,074	
<b>2009 Est. Per Capita Income</b>	\$28,115		\$22,992		\$22,482	

