

# FOR LEASE

## Central Plaza



Central Plaza is located on Central between Oliver and Edgemoor in the well-established Crown Heights area. The center benefits from excellent drive-by traffic along Central Avenue. Tenants include Papa Johns of Wichita and a Farmers Insurance Agency.

**Location:** 5231 E. Central, Wichita, KS

**Space Available:** 1,000 sq. ft.

**Lease Rate:** \$12.00 sq. ft. NNN

**Demographics:** Est. Average Household Income  
1 Mile = \$67,204 3 Miles = \$52,304 5 Miles = \$53,497

**Signage:** Pylon Signage is available

**Area Neighbors:** Sonic, Dairy Queen, Quik Trip, Burger King, McDonald's, 1 Hour Picture Perfect, Interstate Battery Center, Jiffy Lube and Box Central.

**For More Information Contact:**

Gary Oborny

T: (316) 262-3331

F: (316) 262-6321

C: (316) 992-6720

[gary@occmgmt.com](mailto:gary@occmgmt.com)

[www.occmgmt.com](http://www.occmgmt.com)



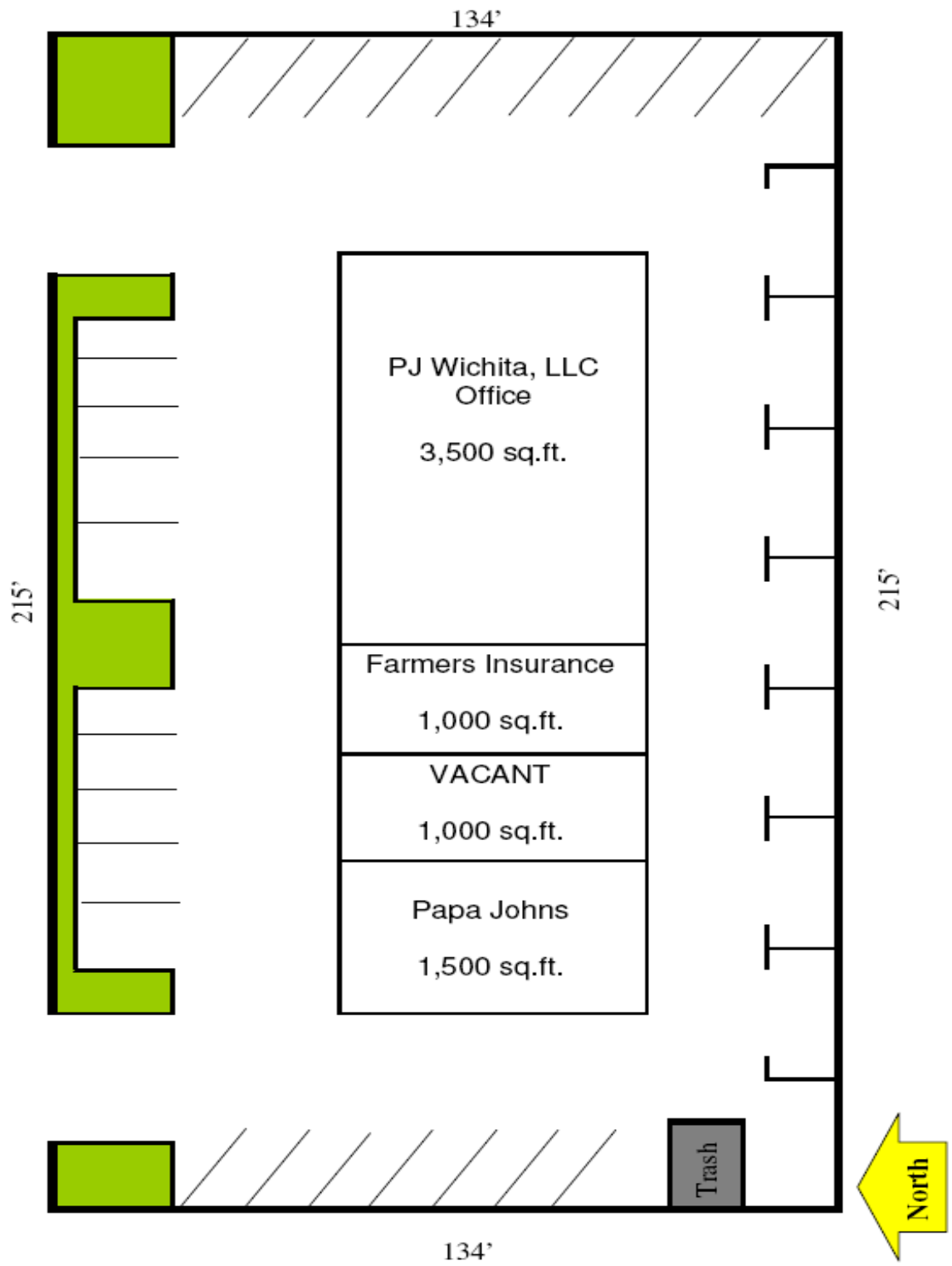

# Area Map

Prepared For:

Order #: 968867244  
Site: 01

5231 E CENTRAL AVE  
WICHITA, KS 67208-4195  
Coord: 37.693658, -97.275528  
Radius - See Appendix for Details

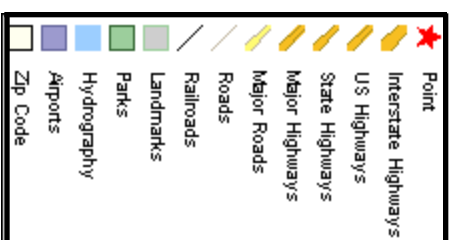
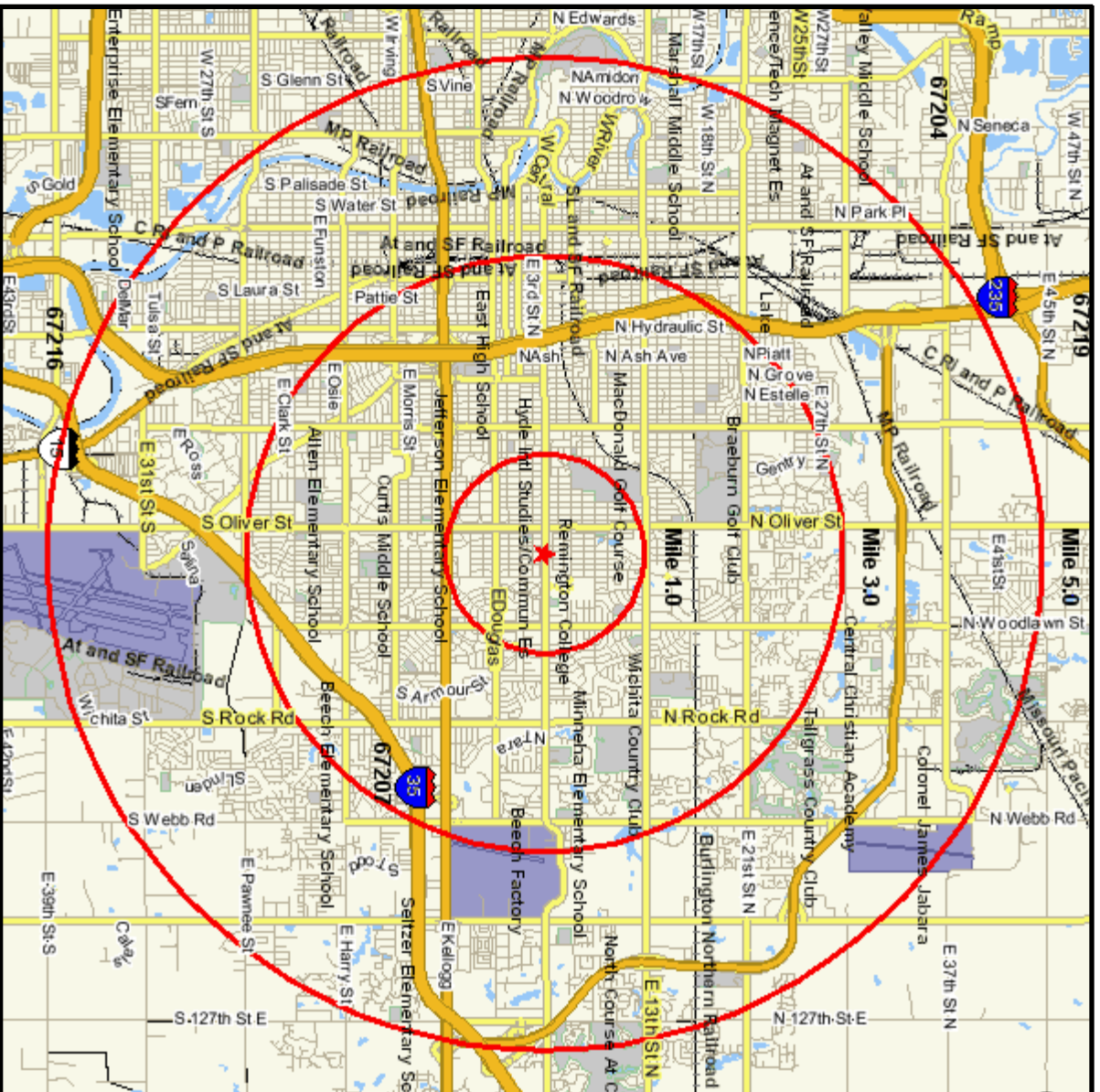

## Pop-Facts: Household Quick Facts Report

**Radius 1: 5231 E CENTRAL AVE, WICHITA, KS 67208-4195, aggregate**

**Radius 2: 5231 E CENTRAL AVE, WICHITA, KS 67208-4195, aggregate**

**Radius 3: 5231 E CENTRAL AVE, WICHITA, KS 67208-4195, aggregate**

Description	0.00 - 1.00 miles		0.00 - 3.00 miles		0.00 - 5.00 miles	
	Radius 1	%	Radius 2	%	Radius 3	%
<b>Households</b>						
2015 Projection	5,720		42,540		85,920	
2010 Estimate	5,610		42,194		84,658	
2000 Census	5,461		42,116		82,845	
1990 Census	5,521		41,661		79,123	
Growth 2010 - 2015	1.96%		0.82%		1.49%	
Growth 2000 - 2010	2.73%		0.19%		2.19%	
Growth 1990 - 2000	-1.09%		1.09%		4.70%	
<b>2010 Est. Households by Household Income</b>	5,610		42,194		84,658	
Income Less than \$15,000	526	9.38	7,579	17.96	13,575	16.04
Income \$15,000 - \$24,999	542	9.66	6,057	14.36	11,563	13.66
Income \$25,000 - \$34,999	716	12.76	5,899	13.98	11,714	13.84
Income \$35,000 - \$49,999	924	16.47	6,972	16.52	14,331	16.93
Income \$50,000 - \$74,999	1,269	22.62	7,696	18.24	16,070	18.98
Income \$75,000 - \$99,999	699	12.46	3,662	8.68	8,142	9.62
Income \$100,000 - \$124,999	415	7.40	1,826	4.33	4,139	4.89
Income \$125,000 - \$149,999	207	3.69	924	2.19	1,959	2.31
Income \$150,000 - \$199,999	130	2.32	604	1.43	1,342	1.59
Income \$200,000 - \$499,999	148	2.64	804	1.91	1,507	1.78
Income \$500,000 or more	34	0.61	171	0.41	318	0.38
<b>2010 Est. Average Household Income</b>	67,103		52,460		54,158	
<b>2010 Est. Median Household Income</b>	51,919		38,361		40,734	
<b>2010 Est. Per Capita Income</b>	28,014		23,034		22,712	
<b>2010 Median HH Inc. by Single Race Class</b>						
White Alone	57,463		43,624		44,258	
Black or African American Alone	37,588		30,740		31,571	
American Indian and Alaska Native Alone	57,692		39,709		40,108	
Asian Alone	24,194		26,280		40,573	
Native Hawaiian and Other Pacific Islander Alone	10,000		37,500		39,688	
Some Other Race Alone	40,114		27,417		32,419	
Two or More Races	42,188		33,918		36,688	
Hispanic or Latino	40,500		30,155		33,457	
Not Hispanic or Latino	52,714		39,379		41,819	

## Pop-Facts: Household Quick Facts Report

**Radius 1: 5231 E CENTRAL AVE, WICHITA, KS 67208-4195, aggregate**

**Radius 2: 5231 E CENTRAL AVE, WICHITA, KS 67208-4195, aggregate**

**Radius 3: 5231 E CENTRAL AVE, WICHITA, KS 67208-4195, aggregate**

Description	0.00 - 1.00 miles		0.00 - 3.00 miles		0.00 - 5.00 miles	
	<i>Radius 1</i>	%	<i>Radius 2</i>	%	<i>Radius 3</i>	%
<b>2010 Est. Households by Household Type</b>	5,610		42,194		84,658	
Family Households	3,511	62.58	23,681	56.12	49,346	58.29
Non Family Households	2,100	37.43	18,513	43.88	35,313	41.71
<b>2010 Est. Group Quarters Population</b>	108		1,191		4,273	
<b>2010 Est. Households by Household Size</b>	5,610		42,194		84,658	
1-person household	1,719	30.64	15,609	36.99	29,516	34.86
2-person household	1,922	34.26	13,019	30.86	25,395	30.00
3-person household	854	15.22	5,995	14.21	12,262	14.48
4-person household	598	10.66	4,155	9.85	9,427	11.14
5-person household	340	6.06	2,125	5.04	4,809	5.68
6-person household	113	2.01	815	1.93	2,000	2.36
7 or more person household	64	1.14	477	1.13	1,251	1.48
<b>2010 Est. Average Household Size</b>	2.38		2.26		2.37	
<b>2010 Est. Household Type, Presence Own Children</b>	5,610		42,194		84,658	
Married-Couple Family, own children	951	16.95	5,607	13.29	13,815	16.32
Married-Couple Family, no own children	1,457	25.97	9,053	21.46	18,282	21.60
Male Householder, own children	126	2.25	1,101	2.61	2,424	2.86
Male Householder, no own children	84	1.50	875	2.07	1,781	2.10
Female Householder, own children	629	11.21	4,759	11.28	8,865	10.47
Female Householder, no own children	263	4.69	2,286	5.42	4,180	4.94

## Pop-Facts: Population Quick Facts Report

**Radius 1: 5231 E CENTRAL AVE, WICHITA, KS 67208-4195, aggregate**

**Radius 2: 5231 E CENTRAL AVE, WICHITA, KS 67208-4195, aggregate**

**Radius 3: 5231 E CENTRAL AVE, WICHITA, KS 67208-4195, aggregate**

Description	0.00 - 1.00 miles <i>Radius 1</i>		0.00 - 3.00 miles <i>Radius 2</i>		0.00 - 5.00 miles <i>Radius 3</i>	
		%		%		%
<b>Population</b>						
2015 Projection	13,759		96,855		207,528	
2010 Estimate	13,482		96,674		204,983	
2000 Census	13,152		97,661		201,607	
1990 Census	13,119		99,107		191,511	
Growth 2010 - 2015	2.05%		0.19%		1.24%	
Growth 2000 - 2010	2.51%		-1.01%		1.67%	
Growth 1990 - 2000	0.25%		-1.46%		5.27%	
<b>2010 Est. Population by Age</b>						
	13,482		96,674		204,983	
Age 0 - 4	1,117	8.29	7,679	7.94	17,438	8.51
Age 5 - 9	1,067	7.91	7,084	7.33	15,768	7.69
Age 10 - 14	994	7.37	6,594	6.82	14,497	7.07
Age 15 - 17	545	4.04	3,603	3.73	7,809	3.81
Age 18 - 20	421	3.12	3,768	3.90	7,987	3.90
Age 21 - 24	678	5.03	5,363	5.55	11,060	5.40
Age 25 - 34	1,709	12.68	14,399	14.89	30,474	14.87
Age 35 - 44	1,911	14.17	12,983	13.43	28,981	14.14
Age 45 - 54	1,785	13.24	12,228	12.65	26,577	12.97
Age 55 - 64	1,474	10.93	9,962	10.30	20,578	10.04
Age 65 - 74	827	6.13	6,009	6.22	11,395	5.56
Age 75 - 84	642	4.76	4,634	4.79	8,142	3.97
Age 85 and over	312	2.31	2,367	2.45	4,277	2.09
Age 16 and over	10,092	74.86	74,060	76.61	154,605	75.42
Age 18 and over	9,760	72.39	71,713	74.18	149,471	72.92
Age 21 and over	9,339	69.27	67,944	70.28	141,485	69.02
Age 65 and over	1,781	13.21	13,010	13.46	23,815	11.62
<b>2010 Est. Median Age</b>						
	36.10		34.89		34.17	
<b>2010 Est. Average Age</b>						
	36.90		36.90		35.80	

## Pop-Facts: Population Quick Facts Report

**Radius 1: 5231 E CENTRAL AVE, WICHITA, KS 67208-4195, aggregate**

**Radius 2: 5231 E CENTRAL AVE, WICHITA, KS 67208-4195, aggregate**

**Radius 3: 5231 E CENTRAL AVE, WICHITA, KS 67208-4195, aggregate**

Description	0.00 - 1.00 miles		0.00 - 3.00 miles		0.00 - 5.00 miles	
	<i>Radius 1</i>	%	<i>Radius 2</i>	%	<i>Radius 3</i>	%
<b>2010 Est. Population by Single Race Classification</b>	13,482		96,674		204,983	
White Alone	9,085	67.39	54,825	56.71	126,150	61.54
Black or African American Alone	3,188	23.65	26,191	27.09	37,705	18.39
American Indian and Alaska Native Alone	87	0.65	923	0.95	2,134	1.04
Asian Alone	336	2.49	5,286	5.47	11,713	5.71
Native Hawaiian and Other Pacific Islander Alone	8	0.06	107	0.11	177	0.09
Some Other Race Alone	360	2.67	5,344	5.53	18,765	9.15
Two or More Races	417	3.09	3,999	4.14	8,341	4.07
<b>2010 Est. Population Hispanic or Latino</b>	13,482		96,674		204,983	
Hispanic or Latino	755	5.60	10,951	11.33	35,125	17.14
Not Hispanic or Latino	12,727	94.40	85,723	88.67	169,858	82.86
<b>2010 Est. Population by Sex</b>	13,482		96,674		204,983	
Male	6,501	48.22	47,104	48.72	101,974	49.75
Female	6,981	51.78	49,569	51.27	103,009	50.25

## Pop-Facts: Demographic Quick Facts Report

**Radius 1: 5231 E CENTRAL AVE, WICHITA, KS 67208-4195, aggregate**

**Radius 2: 5231 E CENTRAL AVE, WICHITA, KS 67208-4195, aggregate**

**Radius 3: 5231 E CENTRAL AVE, WICHITA, KS 67208-4195, aggregate**

Description	0.00 - 1.00 miles <i>Radius 1</i>		0.00 - 3.00 miles <i>Radius 2</i>		0.00 - 5.00 miles <i>Radius 3</i>	
		%		%		%
<b>Population</b>						
2015 Projection	13,759		96,855		207,528	
2010 Estimate	13,482		96,674		204,983	
2000 Census	13,152		97,661		201,607	
1990 Census	13,119		99,107		191,511	
Growth 1990 - 2000	0.25%		-1.46%		5.27%	
<b>Households</b>						
2015 Projection	5,720		42,540		85,920	
2010 Estimate	5,610		42,194		84,658	
2000 Census	5,461		42,116		82,845	
1990 Census	5,521		41,661		79,123	
Growth 1990 - 2000	-1.09%		1.09%		4.70%	
<b>2010 Est. Population by Single Classification Race</b>						
White Alone	9,085	67.39	54,825	56.71	126,150	61.54
Black or African American Alone	3,188	23.65	26,191	27.09	37,705	18.39
American Indian and Alaska Native Alone	87	0.65	923	0.95	2,134	1.04
Asian Alone	336	2.49	5,286	5.47	11,713	5.71
Native Hawaiian and Other Pacific Islander Alone	8	0.06	107	0.11	177	0.09
Some Other Race Alone	360	2.67	5,344	5.53	18,765	9.15
Two or More Races	417	3.09	3,999	4.14	8,341	4.07
<b>2010 Est. Population Hispanic or Latino</b>						
Hispanic or Latino	755	5.60	10,951	11.33	35,125	17.14
Not Hispanic or Latino	12,727	94.40	85,723	88.67	169,858	82.86
<b>2010 Tenure of Occupied Housing Units</b>						
Owner Occupied	3,970	70.77	22,206	52.63	45,185	53.37
Renter Occupied	1,640	29.23	19,988	47.37	39,474	46.63
<b>2010 Average Household Size</b>						
	2.38		2.26		2.37	

## Pop-Facts: Demographic Quick Facts Report

**Radius 1: 5231 E CENTRAL AVE, WICHITA, KS 67208-4195, aggregate**

**Radius 2: 5231 E CENTRAL AVE, WICHITA, KS 67208-4195, aggregate**

**Radius 3: 5231 E CENTRAL AVE, WICHITA, KS 67208-4195, aggregate**

Description	0.00 - 1.00 miles		0.00 - 3.00 miles		0.00 - 5.00 miles	
	Radius 1	%	Radius 2	%	Radius 3	%
<b>2010 Est. Households by Household Income</b>	5,610		42,194		84,658	
Income Less than \$15,000	526	9.38	7,579	17.96	13,575	16.04
Income \$15,000 - \$24,999	542	9.66	6,057	14.36	11,563	13.66
Income \$25,000 - \$34,999	716	12.76	5,899	13.98	11,714	13.84
Income \$35,000 - \$49,999	924	16.47	6,972	16.52	14,331	16.93
Income \$50,000 - \$74,999	1,269	22.62	7,696	18.24	16,070	18.98
Income \$75,000 - \$99,999	699	12.46	3,662	8.68	8,142	9.62
Income \$100,000 - \$124,999	415	7.40	1,826	4.33	4,139	4.89
Income \$125,000 - \$149,999	207	3.69	924	2.19	1,959	2.31
Income \$150,000 - \$199,999	130	2.32	604	1.43	1,342	1.59
Income \$200,000 - \$499,999	148	2.64	804	1.91	1,507	1.78
Income \$500,000 and over	34	0.61	171	0.41	318	0.38
<b>2010 Est. Average Household Income</b>	67,103		52,460		54,158	
<b>2010 Est. Median Household Income</b>	51,919		38,361		40,734	
<b>2010 Est. Per Capita Income</b>	28,014		23,034		22,712	
<b>2010 Median HH Inc by Single Race Class or Ethn</b>						
White Alone	57,463		43,624		44,258	
Black or African American Alone	37,588		30,740		31,571	
American Indian and Alaska Native Alone	57,692		39,709		40,108	
Asian Alone	24,194		26,280		40,573	
Native Hawaiian and Other Pacific Islander Alone	10,000		37,500		39,688	
Some Other Race Alone	40,114		27,417		32,419	
Two or More Races	42,188		33,918		36,688	
Hispanic or Latino	40,500		30,155		33,457	
Not Hispanic or Latino	52,714		39,379		41,819	